



PocketLIM 5G V 2.0 (5" or 7" screens)

MULTI-APPLICATIONS DATA ACQUISITION UNIT

(DRILLING, IN-SITU TESTS, GROUTING, ...)

The PocketLIM 5G is a compact multi-applications data acquisitions unit

Strengths :

- CAN BUS Technology is used for the data transmission between sensors and acquisition unit, the installation and maintenance are simplified;
- Two standard CAN BUS networks (LIM CAN BUS & Machines CAN BUS);
- Using-friendly HMI (Human Machine Interface): colour screen & touch screen (5" or 7" TFT 16/9) with icons, colours codes & virtual keyboard;
- 4 buttons below the screen are doubling functions of the touch screen ;
- Very large memory capacity (2GB corresponding to millions meters/ft);
- Automatic synchronization and data transfer to USB and/or your computer using 3G/4G GPRS modem or WIFI hotspot;
- Geo-Log 4 + LIM @ Mail data management Internet software, generating automatically your geotechnical report;
- Possibility of remote access for maintenance or help to the driller;
- Virtual PDF printer.

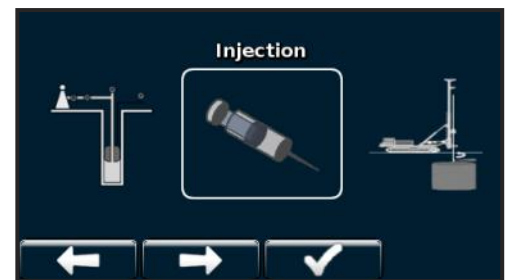

Main PocketLIM 5G Menu to select the application



Machine parameters menu



Tool box menu

<https://lim.eu/en/>



PocketLIM 5G V 2.0 (5" or 7" screens)

MULTI-APPLICATIONS DATA ACQUISITION UNIT

(DRILLING, IN-SITU TESTS, GROUTING, ...)

The different applications of the PocketLIM 5G

DRILLING : Drilling parameters;

DRILL & BLAST: Drill mast positioning + Depth indicator + Drilling parameters + NaviLIM & Drill@LIM options ;

PRESSIO: L.Menard Pressuremeter tests, EN ISO 22476-4 standard;

GEOTECH: DRILLING + PRESSIO;

DPT: Dynamic probing Test (EN ISO 22282-3);

GROUTING : Pumps control ((1 to 4 simultaneously) with grouting parameters acquisition;

LUGEON : Lugeon Packer testing (EN ISO 22282-3);

JET : Jet grouting method monitoring;

CFA : CFA piling method monitoring;

CPT, VIBROFLOTATION, RC DRILLING, ...



Drilling



Grouting

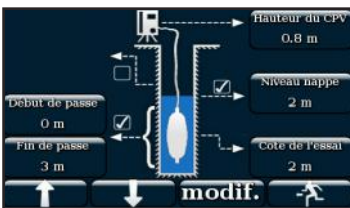

Pressio



DPT



CPT

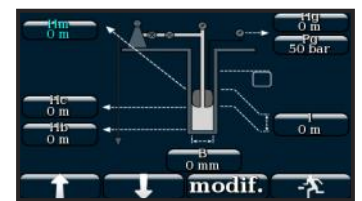

Lugeon



JET



CFA



CFA

Technical specifications:

- 32 bits ARM microprocessor;
- Embedded LINUX kernel (V 2.6) OS;
- Modem GSM/GPRS/EDGE internal modem;
- 1 external USB connector (storage, printer, ...)
- Internal memory : 2Gb (corresponding to millions meters/ft for 4 parameters)
- 5 inches 840 x 480 (16/9) or 7 inches 800 x 480 (16/9), 16-bit color touchscreen, TFT;
- 1 LIM multi-applications CAN BUS;
- 1 machine CAN BUS;

- 4 x "anti vandalism" buttons;
- Weight : 2kg - 4.4 lbs;
- Wifi internal module;
- Dimensions : 157 x 165 x 57mm
- LP GPS positioning (accuracy = 1 m);

Option :

- External printer for on-site printing.



<https://lim.eu/en/>